

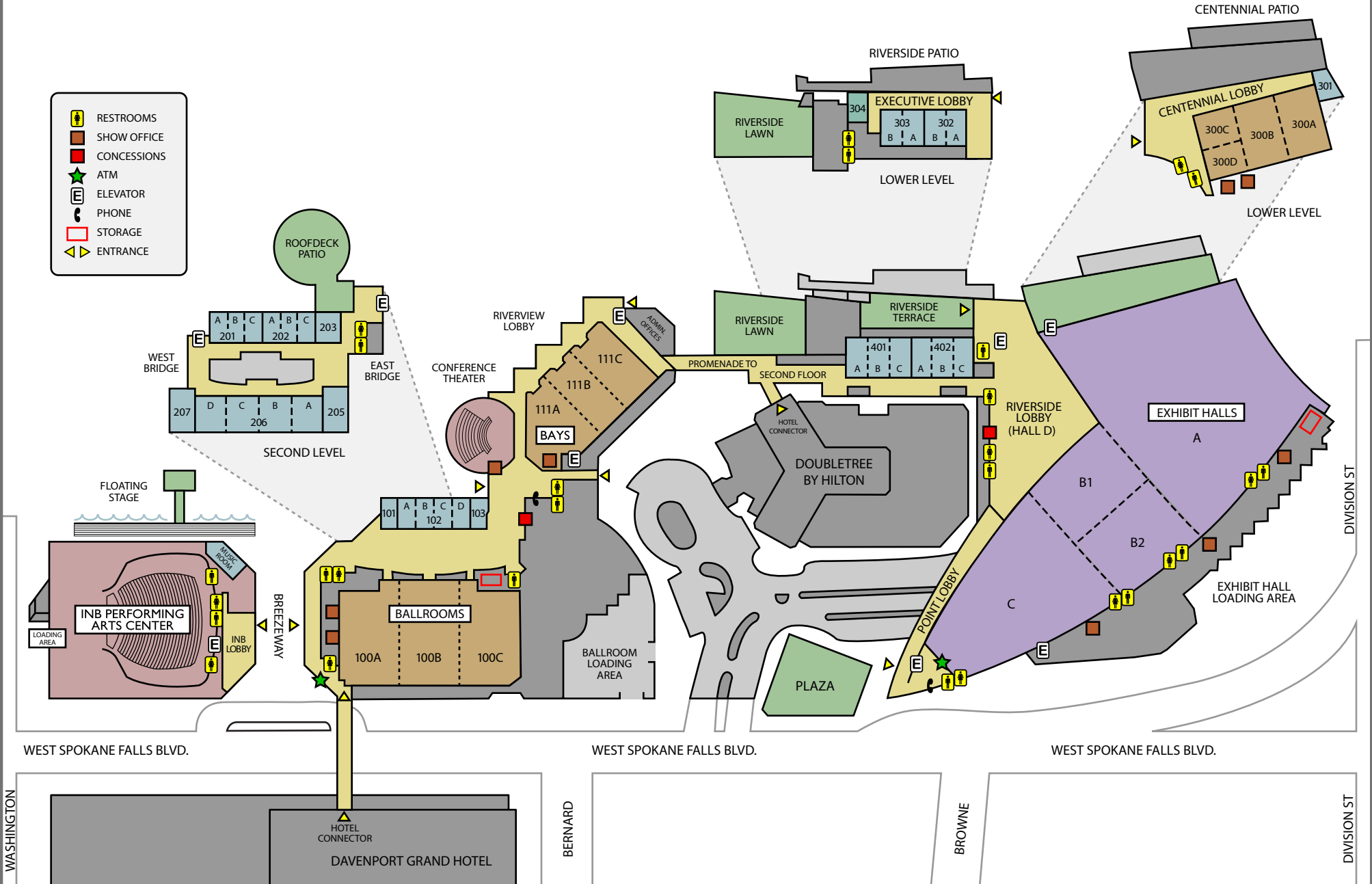

SPOKANE CONVENTION CENTER

- RESTROOMS
- SHOW OFFICE
- CONCESSIONS
- ATM
- ELEVATOR
- PHONE
- STORAGE
- ENTRANCE





SPOKANE CONVENTION CENTER

EXHIBIT HALLS

ROOM NUMBER	SQUARE FOOTAGE	DIMENSIONS	CEILING HEIGHT	BANQUET	THEATER	CLASSROOM	RECEPTION	10 X 10 BOOTHS
HALL A	53,470	210 x 247	30	3,400	5,000	3,000	6,000	283
HALL B	21,790	120 x 180	30	1,400	2,160	1,200	2,160	117
HALL B1	10,529	80 x 116	30	700	1,000	600	1,000	51
HALL B2	11,240	80 x 116	30	700	1,200	600	1,000	51
HALL C	27,510	130 x 210	30	1,800	2,750	1,600	2,750	130
HALL D (RIVERSIDE)	15,000		22	800			1,400	
HALL ABCD	120,000		30	6,600	9,750	5,800	10,750	515

BALLROOMS

100A	8,094	71 x 114	12 - 24	530	840	456	900	37
100B	9,088	71 x 128	12 - 24	570	900	520	900	43
100C	8,094	71 x 114	12 - 24	530	830	456	900	37
100ABC	25,276		12 - 24	1,630	2,525	1,483	2,700	131
111A	4,990	71 x 88	17 - 24	304	450	244	525	20
111B	4,224	48 x 88	17 - 24	296	437	236	475	22
111C	4,224	48 x 88	17 - 24	296	437	236	475	22
111ABC	13,438		17 - 24	896	1,320	752	1,475	71
300A	3,865	78 x 48	20	260	374	230	500	16
300B	3,985	78 x 50	20	260	374	230	500	16
300C	2,027	42 x 48	20	130	186	115	250	8
300D	1,939	39 x 48	20	130	186	115	250	8
300ABCD	12,036	78 x 150	20	800	1,120	690	1,500	54

MEETING ROOMS

101	533	20.5 x 26	12	40	50	32	50
102A	533	20.5 x 26	12	40	50	32	50
102B	533	20.5 x 26	12	40	50	32	50
102C	533	20.5 x 26	12	40	50	32	50
102D	533	20.5 x 26	12	40	50	32	50
103	568	35.5 x 13	10	40	50	32	50
201A	533	20.5 x 26	9.5	40	50	32	50
201B	533	20.5 x 26	9.5	40	50	32	50
201C	533	20.5 x 26	9.5	40	50	32	50
202A	533	20.5 x 26	9.5	40	50	32	50
202B	533	20.5 x 26	9.5	40	50	32	50
202C	533	20.5 x 26	9.5	40	50	32	50
203	741	28.5 x 26	9.5	48	67	40	75
205	1,450	29 x 50	10	80	150	80	160
206A	1,369	37 x 37	10	88	145	80	160
206B	1,369	37 x 37	10	88	145	80	160
206C	1,369	37 x 37	10	88	145	80	160
206D	1,369	37 x 37	10	88	145	80	160
207	1,450	29 x 50	10	80	150	80	160
301	760		9.5	48	67	40	75
302A	1,015	24 x 41	14	60	100	60	125
302B	1,016	24 x 41	14	60	100	60	125
303A	1,016	24 x 41	14	60	100	60	125
303B	1,015	24 x 41	14	60	100	60	125
401A	1,005	39 x 24	14	60	100	60	125
401B	1,018	39 x 25	14	60	100	60	125
401C	1,028	39 x 25	14	60	100	60	125
402A	1,028	39 x 25	14	60	100	60	125
402B	1,028	39 x 25	14	60	100	60	125
402C	1,018	39 x 25	14	60	100	60	125

THEATER

CONF. THEATER	5,782		17 - 24		270		
---------------	-------	--	---------	--	-----	--	--

INB PERFORMING ARTS CENTER

AUDITORIUM					2,700		
MUSIC ROOM		136 x 64	15.5	150	200	120	200
LOBBY							700



BOARD ROOM

ROOM NUMBER	SQUARE FOOTAGE	CEILING HEIGHT	RECEPTION
304	805		30

BOARD STYLE

LOBBIES

BALLROOM LOBBY	7,000	26	500
CONFERENCE THEATER	4,200		300
THE POINT LOBBY	5,800		350
RIVERSIDE LOBBY (HALL D)	17,000	22	1400
RIVERSIDE OVERLOOK	2,506		
RIVERVIEW LOBBY	3,850		
CENTENNIAL LOBBY	9,240		

OUTSIDE SPACES

ROOF DECK	7,173		300
PLAZA			300
BREEZEWAY			300
RIVERSIDE TERRACE	8,230		
RIVERSIDE PATIO	3,000		

NOTE: CAPACITY FIGURES DO NOT ACCOUNT FOR STAGING, DANCE FLOORS OR AUDIO-VISUAL REQUIREMENTS. FINAL SET-UP NUMBER IS SUBJECT TO FIRE MARSHAL APPROVAL.